

Detail D-D
For larger scale see drag no D008

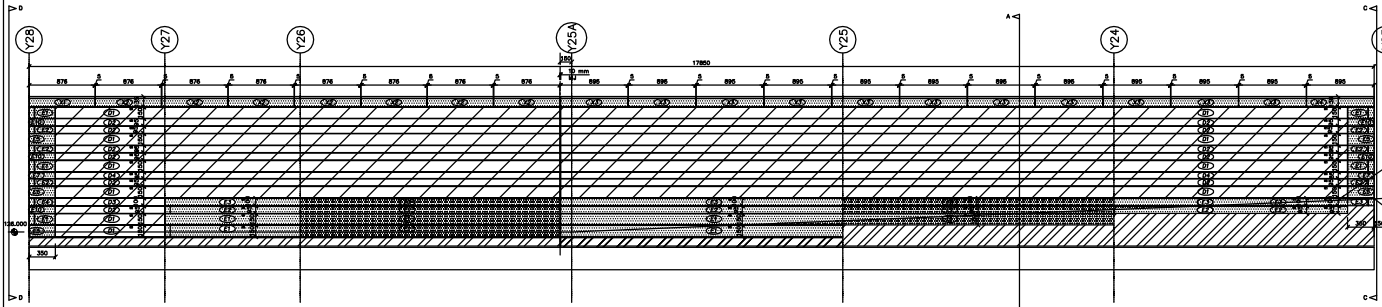

West Elevation to battered wall on Grid Line X28

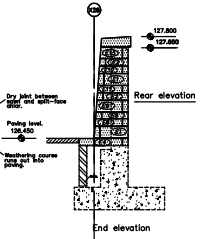

Detail C-C
For larger scale see drag no D008

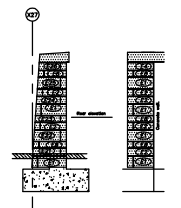

Detail B-B
For larger scale see drag no D008

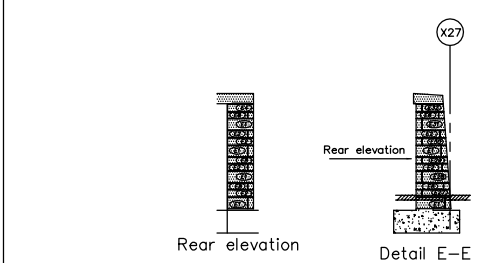

Detail E-E

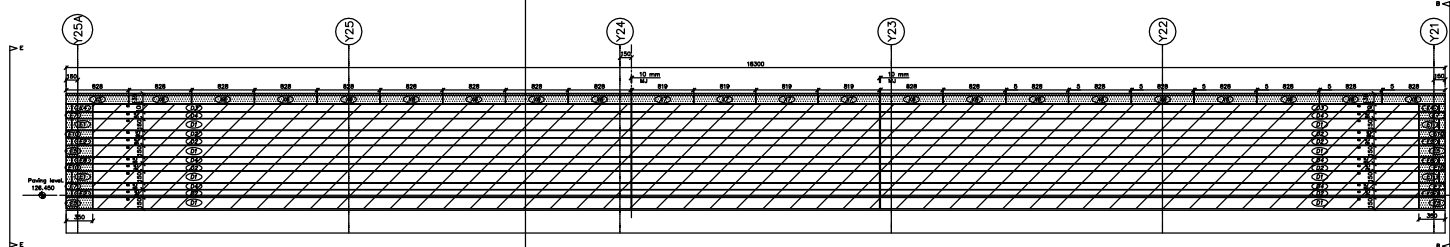

West Elevation on battered wall on Grid Line X27

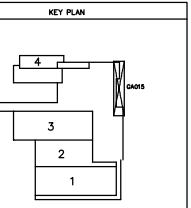

NOTES
COPYRIGHT
Not to be reproduced without written permission.

= Details to be confirmed.

Read in conjunction with drawing No. 98097/ PV001

This drawing has been prepared using Architects drawing nos:
229/20/225
229/20/226
229/20/212
and Engineers drawing Nos:
955/320

Stone type: Crosland Hill Yorkstone
Joint size: 5mm

- Finish : Split face ashlar
- Finish : Sawn face ashlar
- Brickwork

1	4.5.99	stanton williams comments incorporated.
REV.	DATE	AMENDMENT
NOTE - DO NOT SCALE FROM THIS DRAWING		
STATUS		

Contract	Millennium Seed Bank	
Location	Battered wall elevations.	
Architect	stanton williams	
Drawn by	AGM	
Scale	1:25	Date 31.03.99
Order No.	98097	
DRWG. No.	GA015	
Rev.	Rev.1	

